

ADVERTISED DOCUMENT - This document has been copied and made available for the sole purpose of enabling its consideration and review as part of a planning process under the Planning and Environment Act 1987. This information must not be used for any purpose which may breach any copyright.

Stages of Development at which the PA must inspect Tree Protection Measures

Site Establishment

Prior to works commencing through until all Tree Protection Methods are in place. All services will either be located outside of the Tree Protection Zone, bored under the tree protection zone, or installed using hydro excavation under the supervision of the project arborist. Prior to any works commencing including demolition Initial TPF with tree protection signage must be installed as shown on the TPP-D and following installation of the TPF-R must be inspected by the PA to ensure it is in place and protecting the trees adequately.

If required locate temporary infrastructure to minimize impact on retained trees.

Certification of tree protection measures by PA

Pre-Construction

Following Site Establishment prior to construction

Maintain protective measures which must be approved by the PA.

Landscape plan should be checked for compliance with the TPP-D by the PA.

Demolition

Given the TPF and other measures are in place and approved by the PA, demolition can be carried out.

If machinery is used to carry out or help with the demolition, a "long armed" machine such as an excavator must be used that can stand outside any TPZ to carry out any works.

Any works within a TPZ must be carried out by hand if possible and must be supervised by the PA in coordination with the site manager and any workers or others involved.

Construction

Initial induction meeting with PA and project principal / supervisor must be carried out.

Irrigation if required for protected trees must be installed if specified.

Inspection commenced which must be recorded in Project Arborist Notes 4 to 6 Week Inspection Cycles following.

Prior to any construction works commencing Secondary TPF, mulching and planking must be installed if required as defined and approved by the PA. All workers must be briefed by the PA and / or site manager to be careful they do not spill or allow any deleterious substances into the root zone of any tree and to not enter a TPZ without permission from the PA.

When it is necessary to modify the position of TPF to allow any works within a TPZ, such must be supervised by the PA and comply with AS 4970 and our Definitions following, and that information provided to the RA in writing.

Any services must be located outside of any TPZ or located using hydro excavation or bored under any TPZ to a minimum depth of 800 mm and prior approved by the RA in writing.

Certification of tree protection measures by PA and provide in writing to the RA.

Post Construction

Once construction is completed there may be other activities on the site such as landscaping. Given the trees' locations any other works such as landscaping must be supervised by the PA. The landscape plan should be checked for compliance with the TPP-D by the PA.

Installation of irrigation services, control of compaction work, installation of pavement, retaining walls and anything else that could impact upon protected trees must be supervised by the PA.

Following also supervised by PA Remove selected protective measures as necessary, carry out remedial tree works.

Final Certification

The PA must assess the condition of trees and make recommendations for any necessary remedial actions.

Following the PA must certify (as appropriate) that the completed works have been carried out in compliance with the approved plans and specifications for tree protection.

Structures within Tree Protection Zones, Footings and Non-Destructive Root Investigations

If there are structures planned to be built within TPZ, it is impossible without carrying out a Non-Destructive Root Investigation (NDRI) to ascertain what roots may be present within a TPZ that require protection.

Root sensitive footings (e.g. pier and beam, waffle slab, suspended slab, or cantilevered foundations) must be used within the Tree Protection Zone of all retained trees.

If alternative footings are required, they must be approved by the Responsible Authority in writing and may require supporting evidence such as a Non-Destructive Root Investigation.

Any footing within a TPZ must be lined with an impervious membrane to ensure no toxic substances can leach into the root system of a tree.

All excavations within Tree Protection Zones must be directly supervised by the PA and approved by the RA.

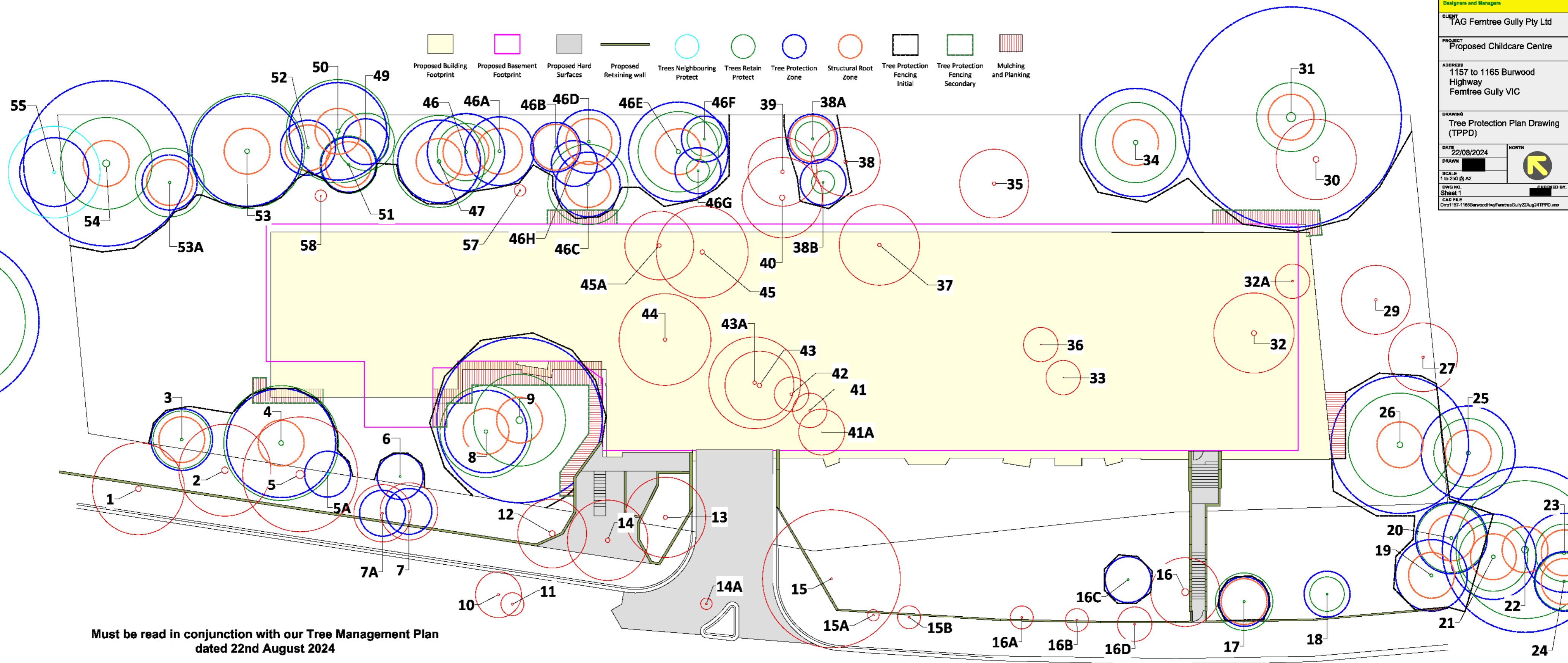

Must be read in conjunction with our Tree Management Plan dated 22nd August 2024

Burwood Highway

COPYRIGHT
This drawing shall not be reproduced, published, copied or used by any party in whole or part without permission.

REV	DATE	BY	AMENDMENTS
NOTES			

LANDSCAPES BY DESIGN
Domestic & Commercial

Landscape Design
Project Management
Tree Reports
Planning Permits
Water Features
Multi Unit
Dual Occupancy
Consultation
Cad Drawings

1300 322 048

www.landscapesbydesign.com.au
www.treereportsmelbourne.com.au
admin@landscapesbydesign.com.au
5 Oakley St
Mount Dandenong
Victoria 3767

Diploma of Horticulture
Diploma of Horticulture - Arboriculture
Member - AILDM - Australian Institute of Landscape Designers and Managers

CLIENT
TAG Femtree Gully Pty Ltd

PROJECT
Proposed Childcare Centre

ADDRESS
1157 to 1165 Burwood Highway
Femtree Gully VIC

DRAWING
Tree Protection Plan Drawing (TPPD)

DATE 22/08/2024	NORTH
DRAWN [Redacted]	
SCALE 1:125 @ A2	
DWG NO. Sheet 1	
CAD FILE Dmt1157-1165BurwoodHwyFemtreeGully22Aug24TPPD.vsw	CHECKED BY [Redacted]